



PUBLIC WORKS DEPARTMENT
ENGINEERING DIVISION
156 S. BROADWAY, SUITE 150
TURLOCK, CA 95380

PHONE: (209) 668-5520
FAX: (209) 668-5563
TDD: (800) 735-2929
engineering@turlock.ca.us

Addendum No. 1

City Project No. 20-013 “Water and Sewer Main Extensions Golden State Blvd.”

April 26, 2022

Plan holders:

****SPECIAL NOTE**** The proposal due date has been extended one week. The deadline for submission of proposals is 3:00 PM on Tuesday, May 10th, 2022.

The following changes and notations shall be made to the project plans and specifications (strikeout text indicates deletions and bold underlined text indicates additions):

Project Specifications:

1. Notice to Contractors

The first paragraph is amended as follows:

Sealed proposals will be received by the City Engineer of the City of Turlock, Development Services/Engineering Division, 156 S. Broadway, Suite 150, Turlock, California 95380, until 3:00 PM on Tuesday, ~~May 3rd~~ **May 10th**, 2022, for:

2. Proposal Submittal Checklist

The first paragraph is amended as follows:

The bidder shall provide a complete proposal in a sealed envelope before 3:00 PM on Tuesday, ~~May 3~~ **May 10**, 2022 at the address shown on the cover sheet of these specifications.

3. Delete the Bidding Form included with the original bid documents and replace with the attached Bidding Form.

4. Special Provision Section 5.29 “Permits”

Permit:	Agency / Division:	Required for:	Fee	Notes
Erosion and Sediment Control Plan	City of Turlock	Any ground disturbing work	\$0	See Special Provisions section “EROSION CONTROL”
<u>Stormwater construction permit</u>	<u>Stanislaus County</u>	<u>Any ground disturbing work</u>	<u>TBD, paid by City direct to County</u>	<u>See Special Provisions section “EROSION CONTROL”</u>
Encroachment Permit	City of Turlock	Any work within City limits, including traffic control	\$0	Issued by City Engineering Division after contract execution
Encroachment Permit	Stanislaus County	Any work outside of City limits (north of Taylor Road), including traffic control	TBD, paid by City direct to County	<u>City has provided a copy of plans and specifications to County personnel with a request for review and approval of the location of new utilities on April 22, 2022. Within 14 days of execution of the agreement,</u> Contractor shall apply for the permit and provide all required information for issuance of a permit. City will assist required with <u>required</u> supplementary information as necessary.
Monthly Hydrant Use Permit	City of Turlock Municipal Services Department	Use of construction water from hydrants	\$0, though a deposit is required for meter	See Special Provisions section “USE OF HYDRANTS FOR CONSTRUCTION PURPOSES”

5. Special Provisions Section 10.05 “Erosion Control”

The section is amended as follows:

10.05 EROSION CONTROL:

Contractor is required to provide an Erosion and Sediment Control Plan (ESCP) for review and approval by the City of Turlock Engineering Division **for work within the City of Turlock (Sta 0+00 to Sta 27+00)**. A blank ESCP worksheet is available to download from the City's website at <https://ci.turlock.ca.us/buildinginturlock/landdevelopment/improvementplan.asp>. The plan must be approved prior to beginning of work on-site. Contractor shall implement Best Management Practices (BMPs) before construction occurs both in the area of work, as well as staging areas. Contractor shall maintain BMPs in good working condition at all times. Contractor shall provide drain inlet protection, at a minimum. The completed ESCP and required BMPs must be in place prior to soil disturbing construction activities.

Contractor is required to comply with Stanislaus County Stormwater Submittal requirements for plan review and construction permit issuance for work within Stanislaus County (Sta 27+00 to 49+86). Contractor shall provide all required information for a "Regulated Project," which includes soil disturbance greater than 5,000 square feet and less than one acre (43,560 square feet).

The contract lump sum price paid for Erosion Control shall include full compensation for preparing the ESCP and implementing the required BMPs complete in place, **complying with Stanislaus County requirements for Stanislaus County stormwater plan review and permit**, as shown on the plans, and as required by law, as specified in the Standard Specifications and these Special Provisions, and as directed by the Engineer.

6. Special Provisions Section 10.06 "Utility Potholing"

Add the following between the 1st and 2nd paragraph:

Potholing within Stanislaus County (Sta 27+00 to 49+86) shall be done per County Standard Plate No. 3-H3 "Potholing for Design and Construction."

7. Special Provisions Section 10.07 "Traffic Control"

The 1st and 2nd paragraphs of this section is amended as follows (other paragraphs remain unaltered):

Contractor shall comply with the City of Turlock Standard Specifications Section 11 "Traffic Safety" **for work within the City of Turlock (Sta 0+00 to 27+00)**. Contractor shall submit a completed Temporary Traffic Control Plan Checklist with submittal of the Temporary Traffic Control Plan. The checklist may be found online at the City's website at https://ci.turlock.ca.us/_pdf/trafficengineeringdoc.asp?id=4

Contractor shall comply with the current Stanislaus County Standards and Specifications for work within Stanislaus County (Sta 27+00 to 49+86). Refer to Chapter 2: Temporary Traffic Control and Safety. Contractor shall submit the

required information related to traffic control to the County with the encroachment permit application.

8. Special Provisions Section 10.09 “Potable Water System”

Insert the added paragraph below the existing paragraph titled 12” PVC WATER MAIN, 6” PVC WATER PIPE:

Where water main pipe is to be installed in Stanislaus County between Station 27+00 and 49+86, Contractor shall install pipe per the current Stanislaus County Standards and Specifications, rather than the City Standards and Specifications. Refer to Chapter 3: Roads and the County standard plate (drawing) numbers:

- 3-H2 “Trenching Requirements in Existing Streets”
- 3-H3 “Potholing for Design and Construction”
 - Contractor shall assume for purposes of bidding that the R-Value of native material exceeds 50 and may be used for backfill as allowed the detail.
- 3-H4 & 3-H5 “Trench Construction Notes”

9. Special Provisions Section 10.09 “Potable Water System”

The 1st and 2nd paragraphs under the MEASUREMENT heading is amended as follows (other paragraphs remain unaltered):

MEASUREMENT:

6” PVC Water Pipe (City – STA 21+60 to 27+00) and 12” PVC Water Main (City – STA 21+60 to 27+00) includes trench excavation, pipe laying, backfill, and trench patching (refer to City Standard drawings T-1 and T-2; trench repair steps 1 and 2) and backfill per City Standards and Specifications and shall be paid for by the linear foot as determined by the Engineer and adjusted by the amount of any change order. Refer to Appendix A – Pavement Coring Report for pavement thicknesses measured in the field. Note that the final step 3 trench repair per City Standard Drawing T-3 shall be paid for under separate bid item “Cold Plane Grind and 2” HMA Overlay (City).”

~~6” PVC Water Pipe includes trench excavation, pipe laying, and backfill and shall be paid for by the linear foot as determined by the Engineer and adjusted by the amount of any change order.~~

6” PVC Water Pipe (County – STA 27+00 to 49+86) and 12” PVC Water Main (County – STA 27+00 to 49+86) includes sawcutting, trench excavation, pipe laying, and backfill to finished subgrade per Stanislaus County Standards and

Specifications and shall be paid for by the linear foot as determined by the Engineer and adjusted by the amount of any change order. Note that trench patching, which includes the structural section within the trench patch zone per County Standard Plate No. 3-H2, shall be paid for under separate bid item “Trench Patching (County – Sta 27+00 to 49+86).”

10. Special Provisions Section 10.10 “Cold Plane Grind and 2” HMA Overlay”

The heading and first paragraph are amended as follows (other paragraphs remain unaltered):

10.10.1 COLD PLANE GRIND AND 2” HMA OVERLAY (City – Sta 10+47 to 27+00):
This work includes the final step 3 trench repair per City Standard Drawing T-3 as included in ~~Trench patching shall be in accordance with~~ Section 14 “Trenching and Backfilling” of the City of Turlock Standard Specifications and Drawings, Errata 1, ~~the plans and these special provisions.~~

11. Special Provisions

The following section is added:

10.10.2 TRENCH PATCHING (COUNTY – STA 27+00 to 49+86):
This work includes the placement of the structural section in the trench patch zone within Stanislaus County and shall conform to the Stanislaus County Standards and Specifications. Refer to Appendix A – Pavement Coring Report for pavement thicknesses measured in the field.

The contract price paid per square feet for Trench Patching (County – Sta 27+00 To 49+86) shall include full compensation for furnishing all labor, materials, tools, equipment, and incidentals and for doing all the work involved in placing structural section materials as required per Stanislaus County Standards and Specifications within the trench patch zone, and as directed by the Engineer.

12. Special Provisions Section 10.11 “Minor Concrete (Curb, Gutter and Sidewalk)”

The section is amended as follows:

10.11 MINOR CONCRETE (CURB, GUTTER AND SIDEWALK):
Minor Concrete shall conform to the requirements of Section 13 of the City of Turlock Standard Specifications and Drawings.

The surface of all concrete shall be finished with a steel trowel to a dense, hard, smooth finish, followed by a light broom finish. Addition of water to the surface to facilitate brooming will not be permitted under any circumstances. The finish surface shall not vary

more than 1/8 inch from a 10 foot straight-edge laid along the surface of the curb, gutter and sidewalk. The finish surface shall be free of all blemishes.

Contractor shall submit a certificate of compliance for all minor concrete.

Fire hydrant runs will impact existing frontage improvements. Per section 14-1 of the City Standard Specifications (Errata 1), when utilities are to be placed crossing under existing frontage improvements (i.e. curb and gutter, sidewalk, driveway approaches, etc.), the improvements shall be removed to existing expansion joints and/or weakened plane joints, and shall be paid for as part of the bid item for "Demolition, Removal, and Abandonment." As the exact location of the proposed fire hydrant in relation to joints is unknown, the bid form includes an estimate of ten (10) lineal feet of curb and gutter and fifty (50) square feet of sidewalk per fire hydrant run. Contractor shall replace the frontage improvements per section 14-1 of the City Standard Specifications and the **actual quantities placed shall be paid for under the respective bid items.**

Contractor is required to install fire hydrant runs across existing concrete medians at various locations as shown on the plans. Contractor shall replace concrete in kind within the required demolition area to allow for trenching, pipe installation, and backfill operations. Contractor shall construct medians per City of Turlock standards and specifications with vertical curb along the perimeter and sidewalk between.

Quantities of Minor Concrete (Curb and Gutter) to be paid for by the lineal foot include earthwork, forming, pouring and finishing minor concrete and will be calculated on the basis of the actual length measured in the field.

Quantities of Minor Concrete (Sidewalk) to be paid for by the square foot include earthwork, forming, pouring and finishing minor concrete and will be calculated on the basis of the actual area measured in the field.

Quantities of Minor Concrete (Median Replacement) shall be paid for by the lump sum and shall include earthwork, forming, pouring and finishing minor concrete where existing concrete median is required to be removed for installation of fire hydrant runs and is based on the location and number of fire hydrant runs as shown on the original bid plans.

13. Special Provisions Section 10.14 "PVC Sanitary Sewer Pipe"

The section is amended as follows:

10.14 PVC SANITARY SEWER PIPE:

Contractor shall install sanitary sewer pipe in accordance with the Standard Specifications and Drawings, the project plans and these special provisions.

Where sanitary sewer pipe is to be installed in Stanislaus County between Station 27+00 and 49+86, Contractor shall install pipe per the current Stanislaus County Standards and Specifications, rather than the City Standards and Specifications. Refer to Chapter 3: Roads and the following standard plate (drawing) numbers:

- 3-H2 “Trenching Requirements in Existing Streets”
- 3-H3 “Potholing for Design and Construction”
 - Contractor shall assume for purposes of bidding that the R-Value of native material exceeds 50 and may be used for backfill as allowed per the detail.
- 3-H4 & 3-H5 “Trench Construction Notes”

Pipe material shall be 18” PVC SDR-35, 12” PVC SDR-26 and 8” PVC SDR-26 sanitary sewer pipe or approved equal. Contractor shall dig, lay, and backfill sanitary sewer pipe in accordance with Standard Specifications Section 14 (Errata 1), the project plans, and these special provisions.

Quantities of sanitary sewer pipe to be paid for on the linear foot shall be calculated on the basis of the actual installed length of pipe in the horizontal plane as verified in the field by the Engineer. Specifically included in the measurement and payment of 18” PVC SDR-35, 12” PVC SDR-26 and 8” PVC SDR-26 sanitary sewer pipe is the trenching, excavation and replacement of any improvements that are disturbed due to the installation of the pipe.

The contract price paid per linear foot for PVC sanitary sewer pipe shall include full compensation for furnishing all labor, materials, tools, equipment, and incidentals and for doing all the work involved in constructing and testing the 18” PVC SDR-35, 12” PVC SDR-26 and 8” PVC SDR-26 sanitary sewer pipe, complete in place, as shown on the plans, and as required by law, as specified in the City of Turlock Standard Specifications and these Special Provisions, and as directed by the Engineer.

The contract price paid per linear foot for 18” PVC SDR-35 Sanitary Sewer Pipe (County – STA 27+00 to 49+98) shall include full compensation for furnishing all labor, materials, tools, equipment, and incidentals and for doing all the work involved in constructing and testing the 18” PVC SDR-35 sanitary sewer pipe, complete in place, as shown on the plans, and as required by law, as specified in the Stanislaus County Standard Specifications and these Special Provisions, and as directed by the Engineer.

Project Plans:

14. Sheet 11

Add the following Stanislaus County Standard Drawings (see attachments to this addendum):

- 3-H2 "Trenching Requirements in Existing Streets"
- 3-H3 "Potholing for Design and Construction"
- 3-H4 & 3-H5 "Trench Construction Notes"

If you have any questions, please call me at (209) 668-5417 or email at SFremming@turlock.ca.us.

Sincerely,



Stephen Fremming, P.E.
Principal Civil Engineer

Attachments:

1. Bidding Form (Addendum No. 1)
2. Stanislaus County Standard Drawings
 - a. 3-H2 "Trenching Requirements in Existing Streets"
 - b. 3-H3 "Potholing for Design and Construction"
 - c. 3-H4 & 3-H5 "Trench Construction Notes"

BIDDING FORM

(Addendum No. 1)

PROJECT TITLE: Water and Sewer Main Extensions Golden State Blvd.

PROJECT NUMBER: 20-013

OPENING DATE: May 10, 2022

OPENING TIME: 3:00 PM

Item No.	Item Description	Unit of Measure	Estimated Quantity	Unit Price	Total
BASE BID					
1	Mobilization and Demobilization	LS	1		
2	Construction Project Sign	EA	2		
3	Demolition, Removal and Abandonment	LS	1		
4	Shoring, Sheeting and Bracing	LS	1		
5	Erosion Control	LS	1		
6	Utility Potholing	LS	1		
7	Traffic Control	LS	1		
8	Temporary Backflow Protection	LS	1		
9	<u>12" PVC Water Main (City - STA 21+60 to 27+00)</u>	<u>LF</u>	<u>540</u>		
10	<u>12" PVC Water Main (County - STA 27+00 to 49+86)</u>	<u>LF</u>	<u>2,286</u>		
11	12" Butterfly Valve	EA	6		
12	Fire Hydrant Assembly	EA	7		
13	Fire Hydrant Assembly with Bollards	EA	10		
14	<u>6" PVC Water Pipe (City - STA 21+60 to 27+00)</u>	<u>LF</u>	<u>859</u>		
15	<u>6" PVC Water Pipe (County - STA 27+00 to 49+86)</u>	<u>LF</u>	<u>216</u>		
16	Connection to Existing Water System	EA	1		
17	Minor Concrete (Curb and Gutter)	LF	198		
18	Minor Concrete (Sidewalk)	SF	1,020		
19	<u>Minor Concrete (Median Replacement)</u>	<u>LS</u>	<u>1</u>		
20	Access ramp (Added Labor and Detectable Warning Only)	EA	2		
21	Sanitary Sewer Manhole	EA	12		
22	<u>18" PVC SDR-35 Sanitary Sewer Pipe (City - STA 10+47 to 27+00)</u>	<u>LF</u>	<u>1,653</u>		
23	<u>18" PVC SDR-35 Sanitary Sewer Pipe (County - STA 27+00 to 49+98)</u>	<u>LF</u>	<u>2,298</u>		
24	12" PVC SDR-26 Sanitary Sewer Pipe	LF	20		
25	Connect to Existing Sewer System	EA	1		
26	<u>Cold Plane Grind and 2" HMA Overlay (City - Sta 10+47 to 27+00))</u>	<u>SF</u>	<u>52,045</u>		
27	<u>Trench Patching (County - Sta 27+00 to 49+86)</u>	<u>SF</u>	<u>33,041</u>		

28	Pavement Striping: Detail 9	LF	2,324		
29	Pavement Striping: Detail 27B	LF	1,800		
30	Pavement Striping: Detail 38	LF	1,491		
31	Type H One Way Yellow Retroreflective Pavement Marker (Detail 26)	EA	54		
32	Type BB Hydrant Pavement Marker	EA	17		
33	12" White Thermoplastic (Crosswalk)	LF	120		
34	White Thermoplastic Pavement Legends (replace existing)	SF	381		
35	Traffic Signal Detector Loop	EA	14		
36	Other required work not included in items 1 through 35	LS	1		
BASE BID TOTAL					

TOTAL BASE BID WRITTEN IN FIGURES: \$ _____, _____, _____ . _____

TOTAL BASE BID WRITTEN IN WORDS: _____

The basis of award shall be the lowest bid price on the base contract without consideration of the prices on the additive items

Item No.	Item Description	Unit of Measure	Estimated Quantity	Unit Price	Total
ADDITIVE BID ALTERNATE "A" - UTILITY SERVICES TO 4475 N. GOLDEN STATE BLVD					
A1	Traffic Control	LS	1		
A2	8" PVC SDR-26 Sanitary Sewer Pipe	LF	80		
A3	Sanitary Sewer Manhole Connection (8")	EA	1		
A4	8" PVC Water (Fire Service)	LF	105		
A5	6" PVC Water (Fire Hydrant Service)	LF	105		
A6	4" PVC Water (Potable)	LF	105		
A7	1.5" PVC Water (Irrigation)	LF	105		
A8	Hot Tap Water Connection, Blowoff, and Gate Valve (8")	EA	1		
A9	Hot Tap Water Connection, Blowoff, and Gate Valve (6")	EA	1		
A10	Hot Tap Water Connection, Blowoff, and Gate Valve (4")	EA	1		
A11	Hot Tap Water Connection (1.5") and meter box	EA	1		
A12	Cold Plane Grind and 2" HMA Overlay	SF	2,750		
A13	Traffic Striping Replacement	LS	1		
A14	Other required work not included in items A1 through A13	LS	1		
ADDITIVE BID ALTERNATE "A" TOTAL					

Item No.	Item Description	Unit of Measure	Estimated Quantity	Unit Price	Total
ADDITIVE BID ALTERNATE "B" - UTILITY SERVICES TO 4475 N. GOLDEN STATE BLVD (COMBINED WATER SERVICE)					
B1	Traffic Control	LS	1		
B2	8" PVC SDR-26 Sanitary Sewer Pipe	LF	80		
B3	Sanitary Sewer Manhole Connection (8")	EA	1		
B4	10" PVC Water (Multi service)	LF	105		
B5	Hot Tap Water Connection, Blowoff, and Gate Valve (10")	EA	1		
B6	Cold Plane Grind and 2" HMA Overlay	SF	1,100		
B7	Traffic Striping Replacement	LS	1		
B8	Other required work not included in items B1 through B7	LS	1		
ADDITIVE BID ALTERNATE "B" TOTAL					

Bidder has examined and carefully studied the Bidding documents and other related data identified in the Bidding Documents and the following Addenda, receipt of which is hereby acknowledged.

ADDENDA

No. _____	Date _____	Signed _____
No. _____	Date _____	Signed _____
No. _____	Date _____	Signed _____
No. _____	Date _____	Signed _____
No. _____	Date _____	Signed _____

CONTRACTOR:

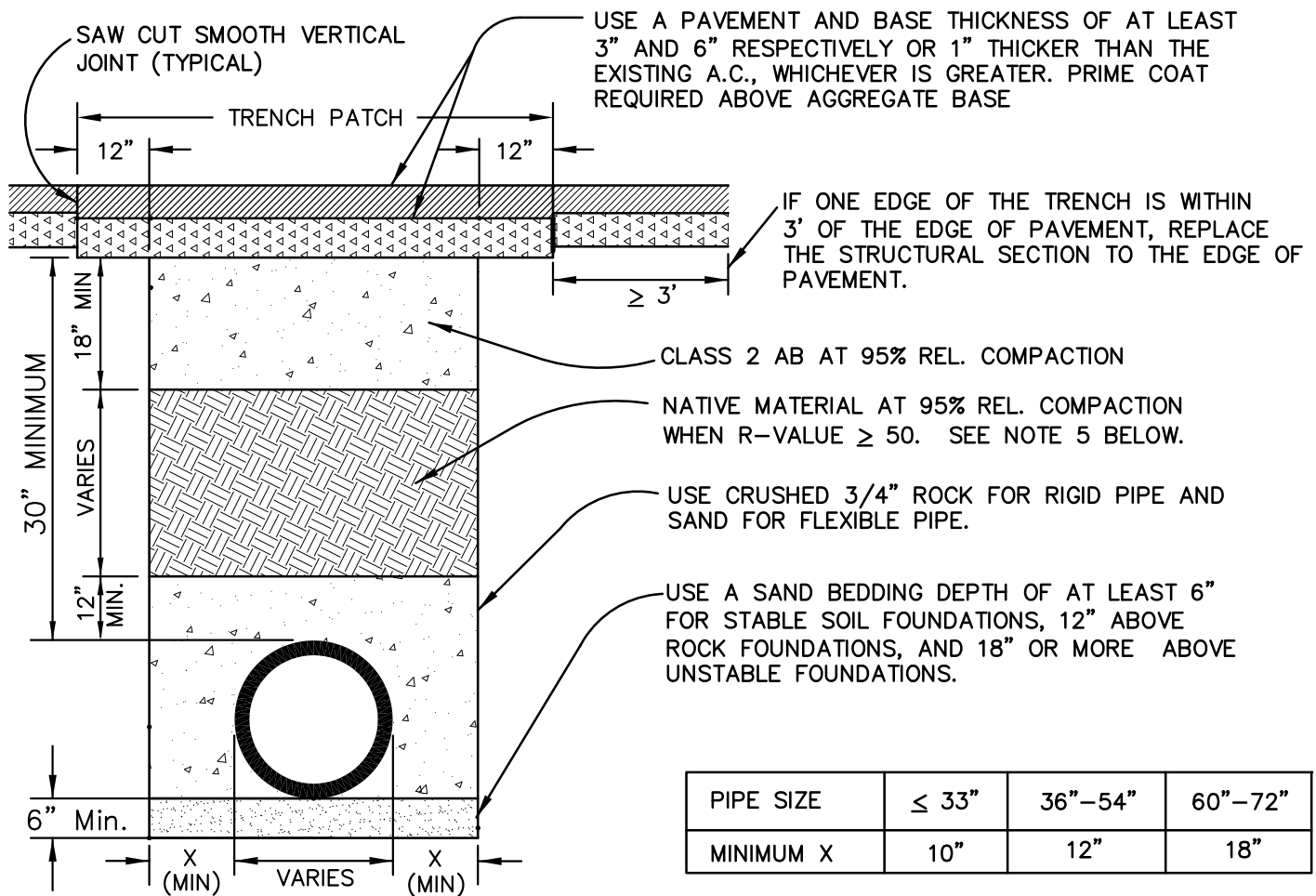

LONGITUDINAL TRENCHES:

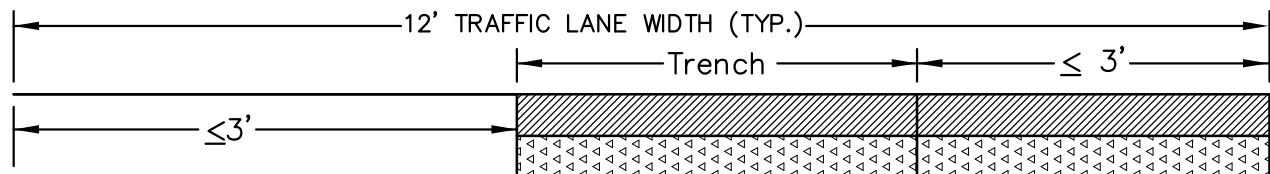

IF THE EDGE OF THE TRENCH IS ≤ 3' FROM THE EDGE OF THE LANE, THEN OVERLAY THE LANE WITH 1" OF AC.

NOTES:

- TRENCHES 5 FT OR MORE IN DEPTH MUST BE SHORED AND PROTECTED IN ACCORDANCE WITH CAL OSHA AND OTHER STATE AND FEDERAL SAFETY CODES, REGULATIONS, AND ORDINANCES.
- ALL PIPES, INCLUDING, BUT NOT LIMITED TO, STORM, WATER, GAS, SEWER, CULVERTS, AND LATERALS SHALL BE A MINIMUM OF 30" BELOW SUB GRADE AT EDGE OF PAVEMENT.
- PROVIDE 95% COMPACTION IN 8" LAYERS FOR THE ENTIRE DEPTH OF TRENCH.
- PONDING OR JETTING WILL NOT BE ALLOWED.
- IF SOIL R-VALUE IS LESS THAN 50, USE CLASS 2 AB VERSUS NATIVE MATERIAL.
- COMPACTION TESTS SHALL BE PERFORMED BY CONTRACTOR AND BE SUBMITTED TO (AND APPROVED) BY COUNTY INSPECTOR PRIOR TO PAVING, USING CALTRANS TEST METHOD NO. 216 AND NO. 231.



NO.	REVISED	BY
UPDATED BY: PAUL SAINI, RCE DONAL HICKS, SR. ENGR. TECH		
CHECKED BY: DAVID LEAMON, RCE		

TRENCHING REQUIREMENTS IN EXISTING STREETS

COUNTY OF STANISLAUS
DEPARTMENT OF PUBLIC WORKS

APPROVED BY:

Matthew Machado

MATTHEW MACHADO, RCE
DIRECTOR OF PUBLIC WORKS

DATE: JUNE 2, 2014

PLATE NO: 3-H2

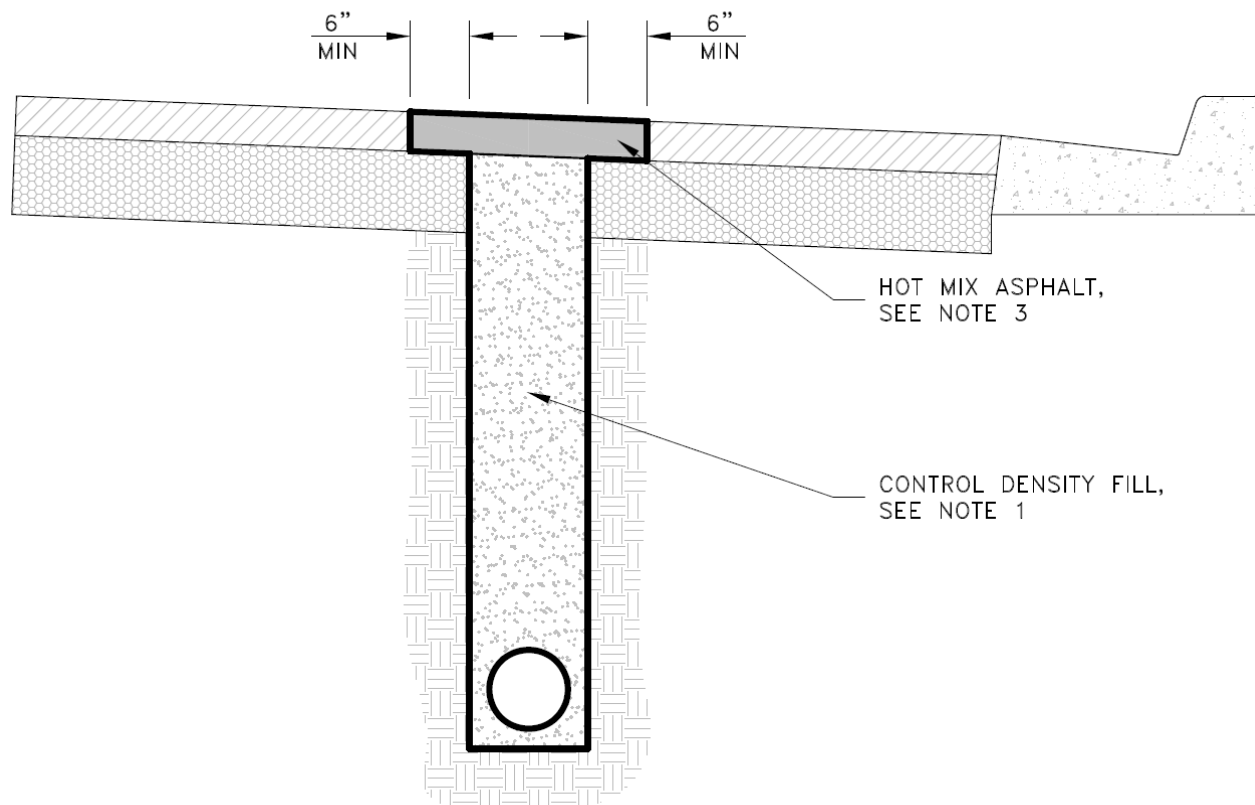

NOTES:

1. TRENCH SECTION SHALL BE BACKFILLED ACCEPTABLE CONTROL DENSITY FILL. CONTRACTOR SHALL FURNISH, INSTALL, COMPACT AND MAINTAIN 2" TEMPORARY PAVEMENT UNTIL PERMANENT PAVEMENT IS PLACED.
2. PRIME COAT REQUIRED ABOVE CONTROL DENSITY FILL.
3. HOT MIX ASPHALT MINIMUM THICKNESS FOR TRENCH RESTORATION SHALL BE DETERMINED BY THE STREET DESIGN CHAPTER OF THESE STANDARD SPECIFICATIONS.



NO.	REVISED	BY
UPDATED BY: PAUL SAINI, RCE DONAL HICKS, SR. ENGR. TECH		
CHECKED BY: DAVID LEAMON, RCE		

POTHOLING FOR DESIGN AND CONSTRUCTION

COUNTY OF STANISLAUS
DEPARTMENT OF PUBLIC WORKS

APPROVED BY:

Matthew Machado

MATTHEW MACHADO, RCE
DIRECTOR OF PUBLIC WORKS

DATE: JUNE 2, 2014

PLATE NO: 3-H3

TRENCH CONSTRUCTION REQUIREMENTS IN COUNTY ROADWAYS

NOTES:

1. UNSTABLE SUBGRADE MATERIAL SHALL BE EXCAVATED AND STABILIZED WITH #3 ROCK (PER ASTM 33 OR APPROVED EQUAL) OR WITH CEMENT SLURRY/CONCRETE AS APPROVED BY THE COUNTY ENGINEER.
2. ALL TRENCHES SHALL BE SHORED OR PROTECTED IN ACCORDANCE WITH OSHA AND OTHER STATE AND FEDERAL SAFETY CODES, REGULATIONS AND ORDINANCES.
3. PLACEMENT OF AGGREGATE BASE SHALL BE IN 12" LIFTS EVENLY PLACED AND MECHANICALLY COMPACTIONED TO RELATIVE DENSITY AS SPECIFIED. COMPACTION TESTS SHALL BE REQUIRED AT THE DISCRETION OF THE COUNTY ENGINEER. ALL COSTS RELATED TO THESE TESTS SHALL BE BORNE BY THE OWNER/CONTRACTOR/UTILITY COMPANY WHEN SUCH TESTS ARE REQUIRED. IF RESULTS OF THESE TESTS DO NOT MEET SPECIFIED REQUIREMENTS, BACKFILL SHALL BE EXCAVATED, REPLACED, COMPACTIONED AND RETESTED. IN CASE OF ONE SACK SLURRY MIX OR CONTROLLED DENSITY FILL, NO COMPACTION TEST WILL BE REQUIRED.
4. DROP HAMMER SHALL NOT BE USED TO CUT PAVEMENT.
5. ALL TRENCHES SHALL BE BACKFILLED AND TEMPORARILY PAVED AT THE END OF EACH WORKING DAY. THE USE OF STEEL PLATES MUST BE APPROVED BY THE COUNTY ENGINEER AT LEAST 48 HOURS IN ADVANCE. A MINIMUM 48 HOUR NOTICE SHALL BE REQUIRED FOR ALL COUNTY INSPECTIONS.
6. INITIAL CUT IN STREET PAVEMENT SHALL BE EQUAL TO THE WIDTH OF THE TRENCH WITH THE OPTION OF BEING JACK HAMMERED OR SAW CUT.
7. FINAL CUT IN STREET PAVEMENT SHALL BE 12" WIDER THAN THE TRENCH WIDTH AS SHOWN IN THE DETAIL AND SHALL BE MADE BY SAW CUTTING ONLY.
8. TEMPORARY BITUMINOUS SURFACING (CUT BACK) SHALL BE PLACED AND COMPACTIONED IMMEDIATELY ABOVE THE TRENCH FOLLOWING COMPACTION AND APPROVED BY THE COUNTY INSPECTOR. MINIMUM DEPTH OF CUT BACK SHALL BE 2" OR AS SPECIFIED BY THE COUNTY ENGINEER. CUT BACK SHALL BE MAINTAINED IN A CONDITION SATISFACTORY TO THE COUNTY INSPECTOR UP TO THE TIME THE FINAL PAVING IS PLACED ON TRENCH.
9. FINAL PAVING ABOVE THE TRENCH SECTION SHALL BE PLACED WITHIN 14 DAYS OF ITS BACKFILL AND COMPACTION. EXTENSION MAY BE GRANTED BY THE COUNTY ENGINEER DUE TO WEATHER CONDITIONS. IN THE EVENT PERMANENT PAVING IS NOT DONE WITHIN 14 DAYS, THE COUNTY MAY CONSIDER THIS AS INCOMPLETE WORK AND MAY TAKE NECESSARY ACTION IN ACCORDANCE WITH PREVAILING COUNTY ORDINANCES AND POLICIES.
10. TEMPORARY CUT BACK SHALL BE REMOVED BEFORE PLACEMENT OF FINAL PAVING. FINAL PAVING SHALL BE PLACED ON UNDISTURBED PREVIOUSLY INSPECTED AND COMPACTIONED AGGREGATE BASE OR ONE SACK SLURRY MIX/CONTROLLED DENSITY FILL. RECOMPACTION SHALL BE REQUIRED FOR ANY DISTURBED BASE OR SURFACE.
11. FOR A PARALLEL TRENCH LONGER THAN ONE HALF LENGTH OF THE BLOCK, A SLURRY SEAL SHALL BE REQUIRED ON THE ENTIRE HALF WIDTH OF THE STREET ON THE TRENCH SIDE AS DIRECTED BY THE COUNTY ENGINEER.
12. PROPER TRAFFIC CONTROLS AND COVERING OF TRENCHES SHALL BE MAINTAINED IN ACCORDANCE WITH THE CHAPTER 2 OF THE COUNTY STANDARD SPECIFICATIONS.
13. TRENCHING SHALL NOT BE ALLOWED ON ANY STREET WHICH HAS BEEN RECONSTRUCTED OR REPAVED WITHIN THE PAST 3 YEARS NOR ON SLURRY SEALED STREETS FOR A PERIOD OF EIGHTEEN (18) MONTHS WITHOUT PRIOR APPROVAL OF THE COUNTY ENGINEER. A TRENCH CUT FEE WILL APPLY.



NO.	REVISED	BY
UPDATED BY: PAUL SAINI, RCE DONAL HICKS, SR. ENGR. TECH		
CHECKED BY: DAVID LEAMON, RCE		

TRENCH CONSTRUCTION NOTES 1 OF 2

COUNTY OF STANISLAUS
DEPARTMENT OF PUBLIC WORKS

APPROVED BY:

MATTHEW MACHADO, RCE
DIRECTOR OF PUBLIC WORKS

DATE: JUNE 2, 2014

PLATE NO: 3-H4

TRENCH CONSTRUCTION REQUIREMENTS IN COUNTY ROADWAYS

NOTES:(CONT.)

13. FOR A PARALLEL TRENCH LONGER THAN ONE HALF LENGTH OF THE BLOCK, A SLURRY SEAL SHALL BE REQUIRED ON THE ENTIRE HALF WIDTH OF THE STREET ON THE TRENCH SIDE AS DIRECTED BY THE COUNTY ENGINEER.
14. PROPER TRAFFIC CONTROLS AND COVERING OF TRENCHES SHALL BE MAINTAINED IN ACCORDANCE WITH THE COUNTY STANDARD SPECIFICATIONS – CHAPTER 2.
15. NO TRENCH SHALL BE OPENED IN ANY STREET FOR THE PURPOSE OF LAYING PIPES OR CONDUITS MORE THAN FIVE HUNDRED (500) FEET AT A TIME.
16. ASPHALT CONCRETE SHALL BE IN ACCORDANCE WITH THE COUNTY STANDARD SPECIFICATIONS – CHAPTER 3.
17. TRENCHING SHALL NOT BE ALLOWED ON ANY STREET WHICH HAS BEEN RECONSTRUCTED OR REPAVED WITHIN THE PAST 3 YEARS NOR ON SLURRY SEALED STREETS FOR A PERIOD OF EIGHTEEN (18) MONTHS WITHOUT APPROVAL OF COUNTY ENGINEER.
A TRENCH CUT FEE WILL BE DETERMINED AT THE TIME OF ENCROACHMENT PERMIT ISSUANCE.



NO.	REVISED	BY
UPDATED BY: PAUL SAINI, RCE DONAL HICKS, SR. ENGR. TECH		
CHECKED BY: DAVID LEAMON, RCE		

TRENCH CONSTRUCTION NOTES 2 OF 2

COUNTY OF STANISLAUS
DEPARTMENT OF PUBLIC WORKS

APPROVED BY:

MATTHEW MACHADO, RCE
DIRECTOR OF PUBLIC WORKS

DATE: JUNE 2, 2014

PLATE NO: 3-H5